

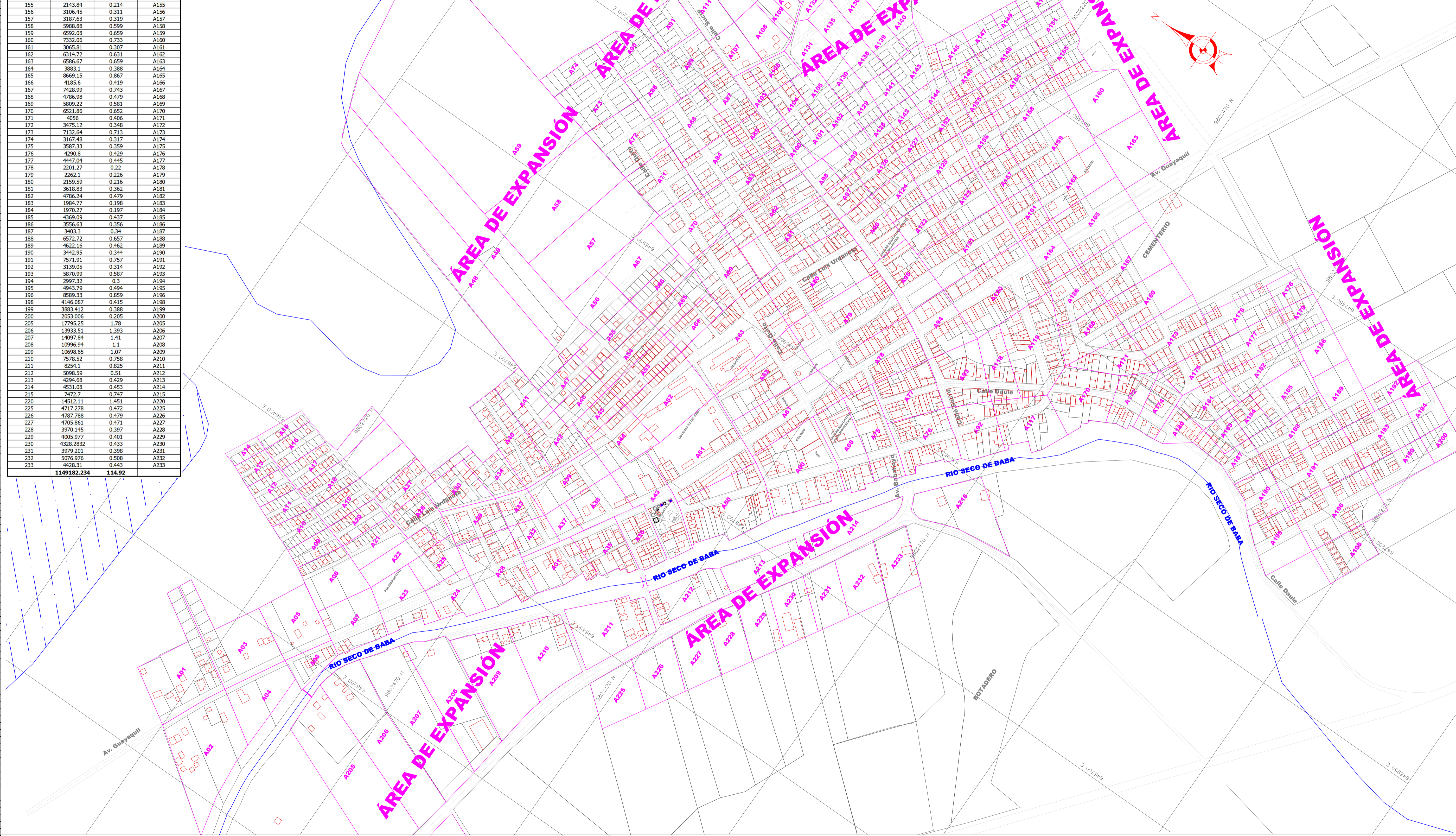

ÁREAS DE APORTE POR CADA NUDO			
NUDOS	AREA (m2)	AREA (Ha)	DESCRIPCION
1	10194.66	1.019	A1
2	12696	1.270	A2
3	9348.32	0.935	A3
4	5680.43	0.568	A4
5	6317.18	0.632	A5
6	2547.96	0.255	A6
7	5577.11	0.558	A7
8	5358	0.536	A8
9	2121.29	0.212	A9
10	2369.21	0.237	A10
11	2083.69	0.208	A11
12	1925.13	0.193	A12
13	1762.13	0.176	A13
14	1088.86	0.109	A14
15	1527.17	0.153	A15
16	2895.59	0.290	A16
17	4434.04	0.443	A17
18	5829.78	0.583	A18
19	5390.41	0.539	A19
20	2558.95	0.256	A20
21	3354.9	0.335	A21
22	3406.71	0.341	A22
23	5394	0.539	A23
24	3677.32	0.368	A24
25	3419.53	0.342	A25
26	3337.63	0.334	A26
27	3908.89	0.391	A27
28	7883.28	0.788	A28
29	3842.91	0.384	A29
30	3952.35	0.395	A30
31	4888.84	0.489	A31
32	2561.45	0.256	A32
33	2234.27	0.223	A33
34	3203.1	0.320	A34
35	4524.32	0.452	A35
36	3755.21	0.376	A36
37	1592.79	0.159	A37
38	4109.84	0.411	A38
39	4990.35	0.499	A39
40	6463.24	0.646	A40
41	3838.53	0.384	A41
42	4043.26	0.404	A42
43	7504.53	0.75	A43
44	5124.78	0.512	A44
45	2340.45	0.234	A45
46	2575.58	0.258	A46
47	2718.25	0.272	A47
48	23821.18	2.382	A48
49	23076.34	2.308	A49
50	9598.13	0.959	A50
51	12088.25	1.209	A51
52	8094.47	0.809	A52
53	3697.17	0.37	A53
54	3564.63	0.356	A54
55	3941.02	0.394	A55
56	4448.43	0.445	A56
57	13420.63	1.342	A57
58	16437.08	1.644	A58
59	58027.78	5.803	A59
60	11180.1	1.118	A60
61	8026.65	0.803	A61
62	8386.12	0.839	A62
63	11726.05	1.173	A63
64	2880.33	0.288	A64
65	3347.07	0.335	A65
66	3160.91	0.316	A66
67	5938.32	0.594	A67
68	5711.79	0.571	A68
69	5787.48	0.579	A69
70	6018.68	0.602	A70
71	5292.11	0.529	A71
72	6744.74	0.674	A72
73	6246.98	0.625	A73
74	3057.79	0.306	A74
75	5830.66	0.583	A75
76	6078.31	0.608	A76
77	5657.09	0.566	A77
78	8425.97	0.843	A78
79	11364.13	1.135	A79
80	11766.5	1.177	A80
81	7221.38	0.722	A81
82	5694.93	0.569	A82
83	6936.64	0.694	A83
84	4821.36	0.482	A84
85	2538.93	0.253	A85
86	6221.42	0.622	A86
87	3646.85	0.365	A87
88	3450.93	0.345	A88
89	5232.2	0.523	A89
90	4321.53	0.432	A90
91	3451.37	0.345	A91
92	4942.01	0.494	A92
93	5865.49	0.587	A93
94	5403.58	0.54	A94
95	5317.47	0.534	A95
96	4655.13	0.466	A96
97	2392.84	0.239	A97
98	1592.5	0.159	A98
99	2849.3	0.285	A99
100	1878.84	0.188	A100
101	2003.81	0.2	A101
102	2107.71	0.211	A102
103	2141.22	0.214	A103
104	2617.94	0.262	A104
105	2620.27	0.262	A105
106	2486.59	0.249	A106
107	3076.58	0.308	A107
108	3344.08	0.334	A108
109	1540.97	0.154	A109
110	1230.1	0.123	A110
111	3791.27	0.379	A111
112	3833.69	0.383	A112
113	2390.36	0.239	A113
114	3094.56	0.3	A114
115	9304.75	0.93	A115
116	9205.94	0.921	A116
117	5938.6	0.594	A117
118	3825.56	0.383	A118
119	9205.75	0.921	A119
120	10704.07	1.07	A120
121	8218.5	0.822	A121
122	3120.59	0.312	A122
123	4914.14	0.491	A123
124	3172.25	0.317	A124
125	4767.73	0.477	A125
126	2636.54	0.263	A126
127	1673.72	0.167	A127
128	1437.44	0.144	A128
129	1916.8	0.192	A129
130	2451.45	0.245	A130
131	3133.46	0.313	A131
132	1187.91	0.119	A132
133	1358.82	0.136	A133
134	429.79	0.044	A134
135	2621.24	0.262	A135
136	2682.64	0.268	A136

ÁREAS DE APORTE POR CADA NUDO			
NUDOS	AREA (m2)	AREA (Ha)	DESCRIPCION
137	2725.26	0.273	A137
138	2448.26	0.245	A138
139	2630.54	0.253	A139
140	2307.28	0.231	A140
141	2117.92	0.212	A141
142	1819	0.182	A142
143	3508.49	0.351	A143
144	2417.84	0.242	A144
145	1907.87	0.191	A145
146	2183.29	0.218	A146
147	1909.79	0.191	A147
148	3441.51	0.344	A148
149	1434.32	0.143	A149
150	2360.59	0.236	A150
151	2573.23	0.257	A151
152	3162.09	0.316	A152
153	1250.3	0.125	A153
154	4359.9	0.436	A154
155	2143.84	0.214	A155
156	3106.45	0.311	A156
157	3187.63	0.319	A157
158	5988.68	0.599	A158
159	6692.08	0.659	A159
160	7332.06	0.733	A160
161	3065.81	0.307	A161
162	6314.72	0.631	A162
163	6586.67	0.659	A163
164	3883.1	0.388	A164
165	8669.15	0.867	A165
166	4185.6	0.419	A166
167	7618.99	0.743	A167
168	4786.98	0.479	A168
169	5809.22	0.581	A169
170	6521.86	0.652	A170
171	4056	0.406	A171
172	3475.12	0.348	A172
173	7132.64	0.713	A173
174	3167.48	0.317	A174
175	3587.33	0.359	A175
176	4290.8	0.429	A176
177	4947.04	0.445	A177
178	2201.27	0.22	A178
179	2262.1	0.226	A179
180	2159.59	0.216	A180
181	3618.83	0.362	A181
182	4786.24	0.479	A182
183	1984.77	0.198	A183
184	1970.27	0.197	A184
185	4369.09	0.437	A185
186	3556.63	0.356	A186
187	3403.3	0.34	A187
188	6572.72	0.657	A188
189	4622.16	0.462	A189
190	3442.95	0.344	A190
191	7571.91	0.757	A191
192	3139.05	0.314	A192
193	5870.99	0.587	A193
194	2997.32	0.3	A194
195	4943.79	0.494	A195
196	8509.33	0.859	A196
198	4146.087	0.415	A198
199	3883.412	0.388	A199
200	2053.006	0.205	A200
205	17795.25	1.78	A205
206	13473.51	1.393	A206
207	14937.84	1.41	A207
208	10996.94	1.1	A208
209	10698.65	1.07	A209
210	7578.52	0.758	A210
211	6254.1	0.625	A211
212	5988.59	0.59	A212
213	4294.68	0.429	A213
214	4531.08	0.453	A214
215	7472.7	0.747	A215
220	1452.11	1.451	A220
225	4712.278	0.472	A225
226	4787.788	0.479	A226
227	4705.861	0.471	A227
228	3970.145	0.397	A228
229	4005.977	0.401	A229
230	4328.2832	0.433	A230
231	3979.201	0.398	A231
232	5076.976	0.508	A232
233	4428.31	0.443	A233
<b>1149182.234</b>		<b>114.92</b>	

**SIMBOLOGÍA**

- PREDIO
- EDIFICACIONES
- EJE DE VIA
- VIA
- ÁREA APORTE





**GOBIERNO AUTONOMO DESCENTRALIZADO  
DEL CANTÓN BABA**

**AB. Jael MeLO OLVERA  
ALCALDESA 2023-2027**

OBRA

**ESTUDIOS DE FACTIBILIDAD Y DISEÑOS DEFINITIVOS DE AGUA POTABLE, ALCANTARILLADO SANITARIO Y ALCANTARILLADO PLUVIAL EN LA CABECERA CANTONAL DE BABA Y VARIOS SECTORES RURALES, PARROQUIA ISLA DE BEJUCAL, PARROQUIA GUARE Y RECINTO LA CARMELA DEL CANTÓN BABA, PROVINCIA DE LOS RÍOS**

CONTIENE

**RED DE DISTRIBUCIÓN AGUA POTABLE - ÁREAS DE APORTE CABECERA CANTONAL DE BABA**

REALIZÓ

ING. HUGO RODRIGUEZ  
CONSULTOR

REVISÓ

ING. MIGUEL VALENCIA  
ADMINISTRADOR DE CONTRATO

ESCALA

1:2800

FECHA

AGOSTO 2024

LAMINA

REDAP-BABA-01